

Simon

The Simon Underglaze has been designed to achieve a higher airflow through a single window. Ideal for single facades where a much higher airflow is required in high and low positions, in order to meet the requirements of Document F.

Simon Underglaze



Specification

- 12,930mm² Equivalent Area per metre.
- Double the Equivalent Area can be achieved by combining the Simon Underglaze with either the Airstrip 19000 or Simon HiGlaze fitted at the top of the window.
- 5,000mm² EA achieved on a length 386mm.
- Glass height reduction is 64mm or 128mm with vent in top of unit.
- Polyester powder coated all aluminium construction.

- Suitable for 20, 24, 28 and 32mm DG units.
- Option of mixed internal/external colours.
- Storm locks available if required, for exposed locations
- Fitted with storm seal in internal flap.
- Manufactured in any RAL or BS colour.
- Thermally broken.

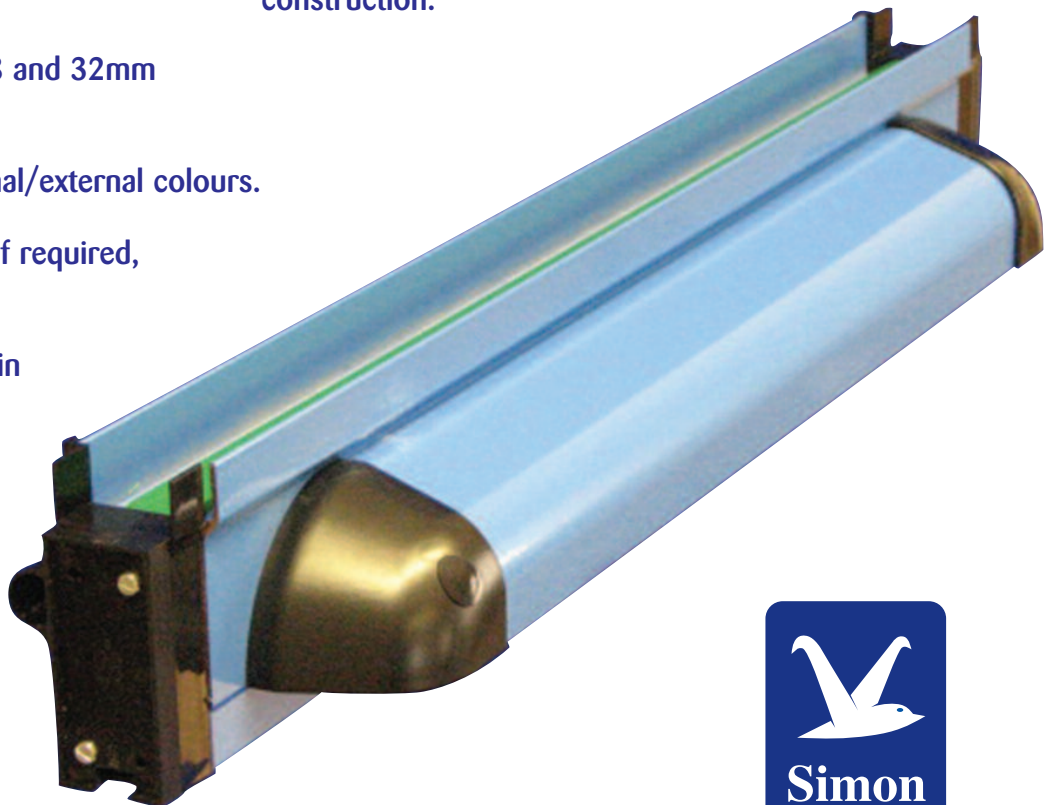

Simon

**Air Management
Systems**

R.W. Simon Limited System Works, Hatchmoor Industrial Estate,
Torrington, Devon EX38 7HP United Kingdom
Tel: 01805 623721 Fax: 01805 624578 E-mail: info@rwsimon.co.uk

Web: www.rwsimon.co.uk

Simon Underglaze

- Fits at the bottom of the sealed unit.
- When used in conjunction with an Airstrip 19000 or the Simon HiGlaze on top of sealed unit, makes this the ideal product for single facades for high and low ventilation.
- A one metre wide window can achieve 25,860mm² EA.
- Tested in accordance with BS 13141-1:2004 achieves 12,930mm² Equivalent Area.
- Using a combination of HiGlaze and Underglaze ventilation, alleviates the need for mechanical extract ventilation

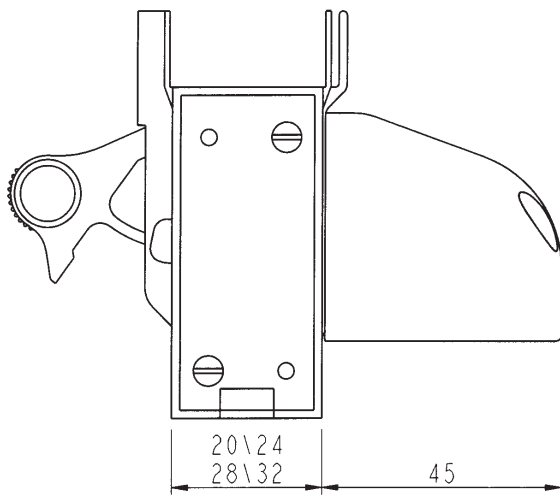
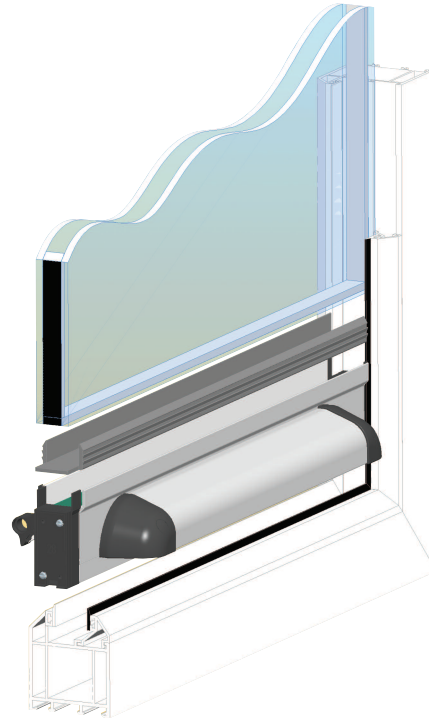

Fitting Instructions - The Simon Underglaze is fitted like any normal glazed-in ventilator, reduce the glass height by the recommended amount and using the U-channel gasket provided simply place the sealed unit in the U-channel on top of the underglaze then fit into frame and bead as normal.

When used in conjunction with an Airstrip 19000 or HiGlaze on top of sealed unit, simply double the glass height reduction and fit the vents on top and bottom of the sealed unit and fit into frame and bead as normal.

The Simon Underglaze is the ideal product to assist in achieving the requirements of Document F where there are a limited number of windows or in particular for dwellings with single facades.

The litres/sec and Equivalent Area figures shown on the table opposite will be doubled for the window, when the Underglaze is used in conjunction with Airstrip 19000 or HiGlaze on the top of the sealed unit.

Pressure Difference (PA)	Volume (litres/second)	Equivalent Area (mm ²)
1	10.16	12,931
2	14.46	13,018
4	20.95	13,109
8	29.37	13,200
10	32.83	13,229
20	46.81	13,319

